



INSTRUCTIONS BOOKLET
FOR INSTALLATION, USE AND MAINTENANCE

INSTALLATION INSTRUCTION OF SOLAR HOT WATER HEATING SYSTEM



2 SOLAR PANEL IN ONE BANK (FPKIT-2) (Distance Between Panel to Panel with Valve & Accessories BOQ)

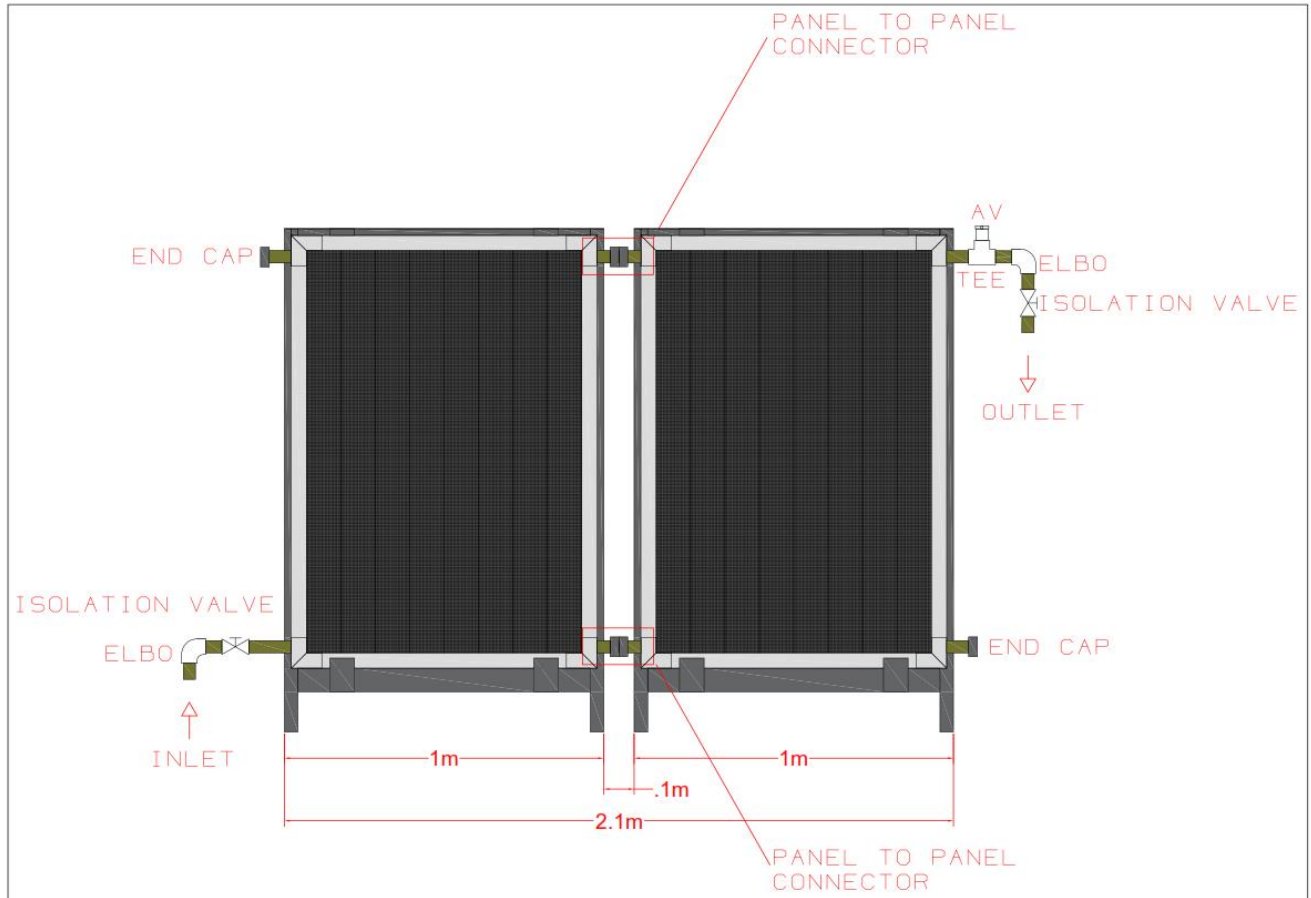

Number of Solar Panel		02 Nos	
Number of Solar Panel Frame		02 Nos	
End Cap 22mm		02 Nos	
SOLAR PANEL INLET			
SR. NO.	ITEM	SIZE	QTY
1	Isolation Valve	3/4"	1
2	Connector Kit	3/4"	1
PANEL TO PANEL KIT			
1	Panel to Panel Connector	3/4"	2
SOLAR PANE OUTLET			
1	Airvent	1/2"	1
2	Isolation Valve	3/4"	1

3 SOLAR PANEL IN ONE BANK (FPKIT-3) (Distance Between Panel to Panel with Valve & Accessories BOQ)

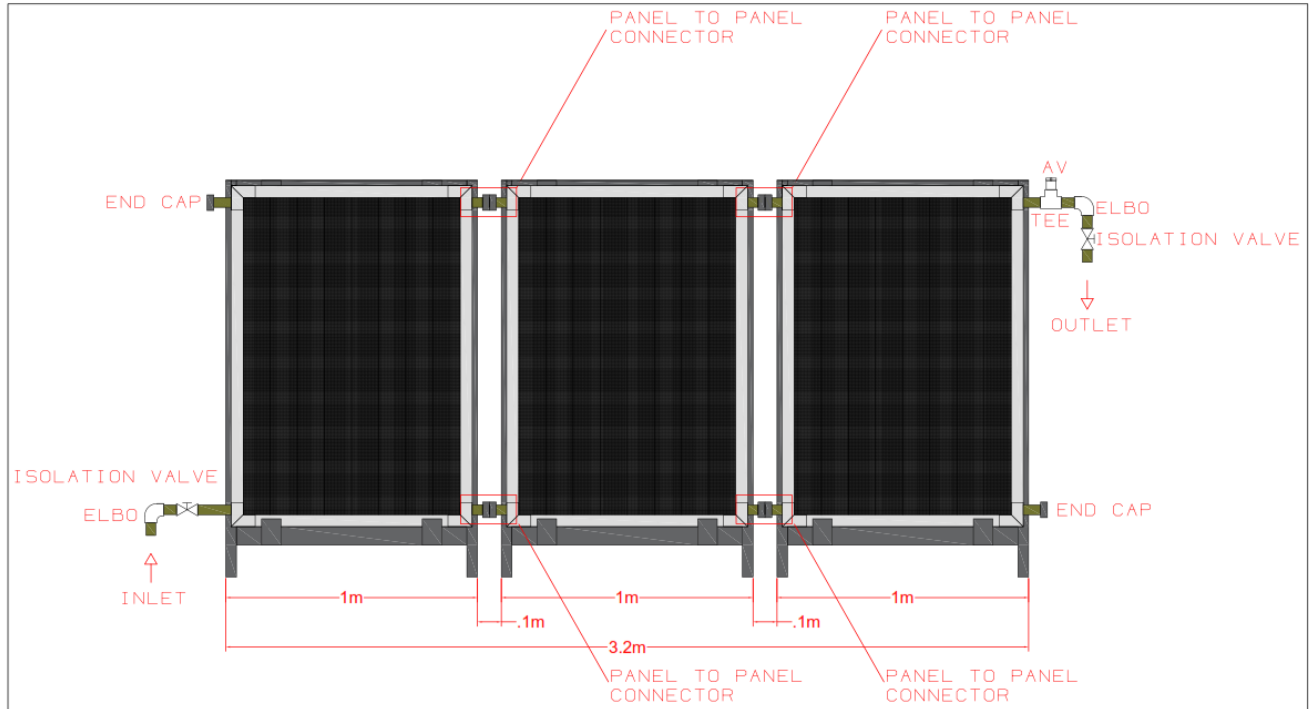

Number of Solar Panel		03 Nos	
Number of Solar Panel Frame		03 Nos	
End Cap 22mm		02 Nos	
SOLAR PANEL INLET			
SR. NO.	ITEM	SIZE	QTY
1	Isolation Valve	3/4"	1
2	Connector Kit	3/4"	1
PANEL TO PANEL KIT			
1	Panel to Panel Connector	3/4"	4
SOLAR PANE OUTLET			
1	Airvent	1/2"	1
2	Isolation Valve	3/4"	1

4 SOLAR PANEL IN ONE BANK (FPKIT-4) (Distance Between Panel to Panel with Valve & Accessories BOQ)

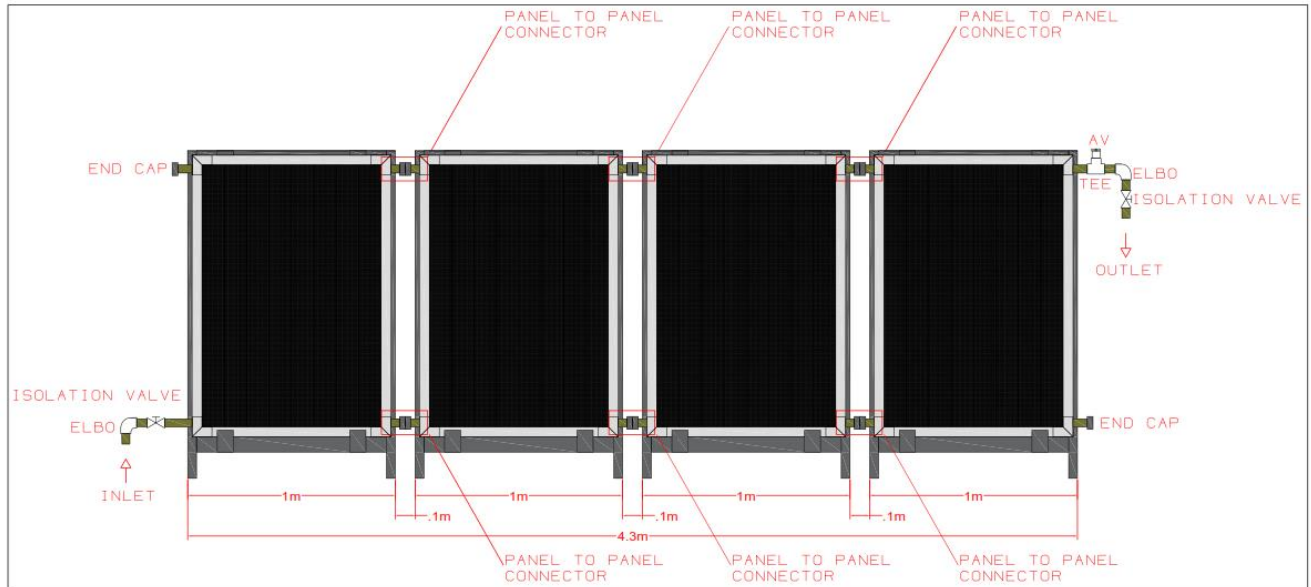

Number of Solar Panel	04 Nos		
Number of Solar Panel Frame	04 Nos		
End Cap 22mm	02 Nos		
SOLAR PANEL INLET			
SR. NO.	ITEM	SIZE	QTY
1	Isolation Valve	3/4"	1
2	Connector Kit	3/4"	1
PANEL TO PANEL KIT			
1	Panel to Panel Connector	3/4"	6
SOLAR PANE OUTLET			
1	Airvent	1/2"	1
2	Isolation Valve	3/4"	1

5 SOLAR PANEL IN ONE BANK (FPKIT-5) (Distance Between Panel to Panel with Valve & Accessories BOQ)

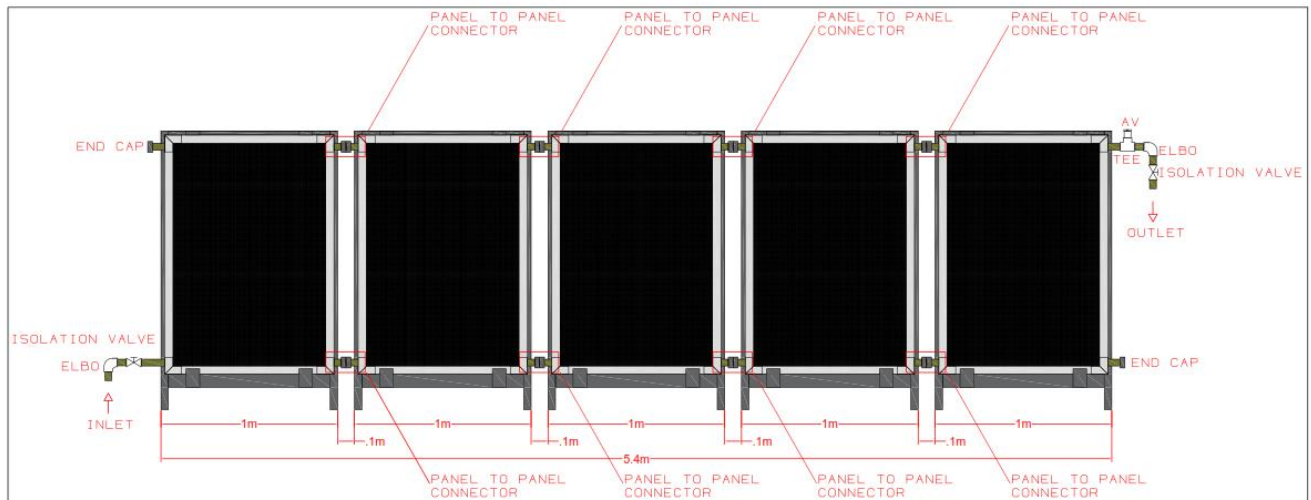

Number of Solar Panel	05 Nos		
Number of Solar Panel Frame	05 Nos		
End Cap 22mm	02 Nos		
SOLAR PANEL INLET			
SR. NO.	ITEM	SIZE	QTY
1	Isolation Valve	3/4"	1
2	Connector Kit	3/4"	1
PANEL TO PANEL KIT			
1	Panel to Panel Connector	3/4"	8
SOLAR PANE OUTLET			
1	Airvent	1/2"	1
2	Isolation Valve	3/4"	1

6 SOLAR PANEL IN ONE BANK (FPKIT-6) (Distance Between Panel to Panel with Valve & Accessories BOQ)

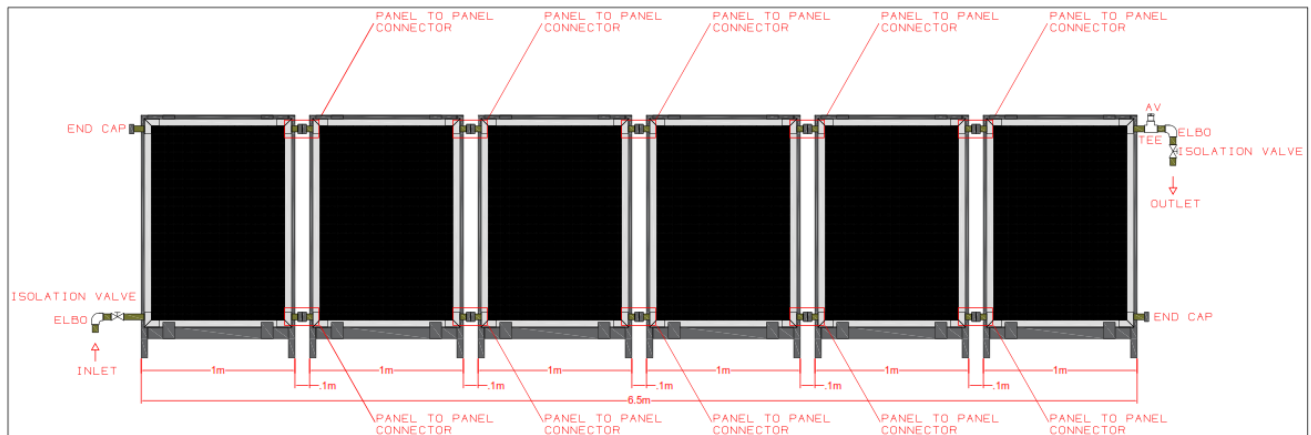

Number of Solar Panel	06 Nos		
Number of Solar Panel Frame	06 Nos		
End Cap 22mm	02 Nos		
SOLAR PANEL INLET			
SR. NO.	ITEM	SIZE	QTY
1	Isolation Valve	3/4"	1
2	Connector Kit	3/4"	1
PANEL TO PANEL KIT			
1	Panel to Panel Connector	3/4"	10
SOLAR PANE OUTLET			
1	Airvent	1/2"	1
2	Isolation Valve	3/4"	1

Solar Panel Frame Angle of Inclination

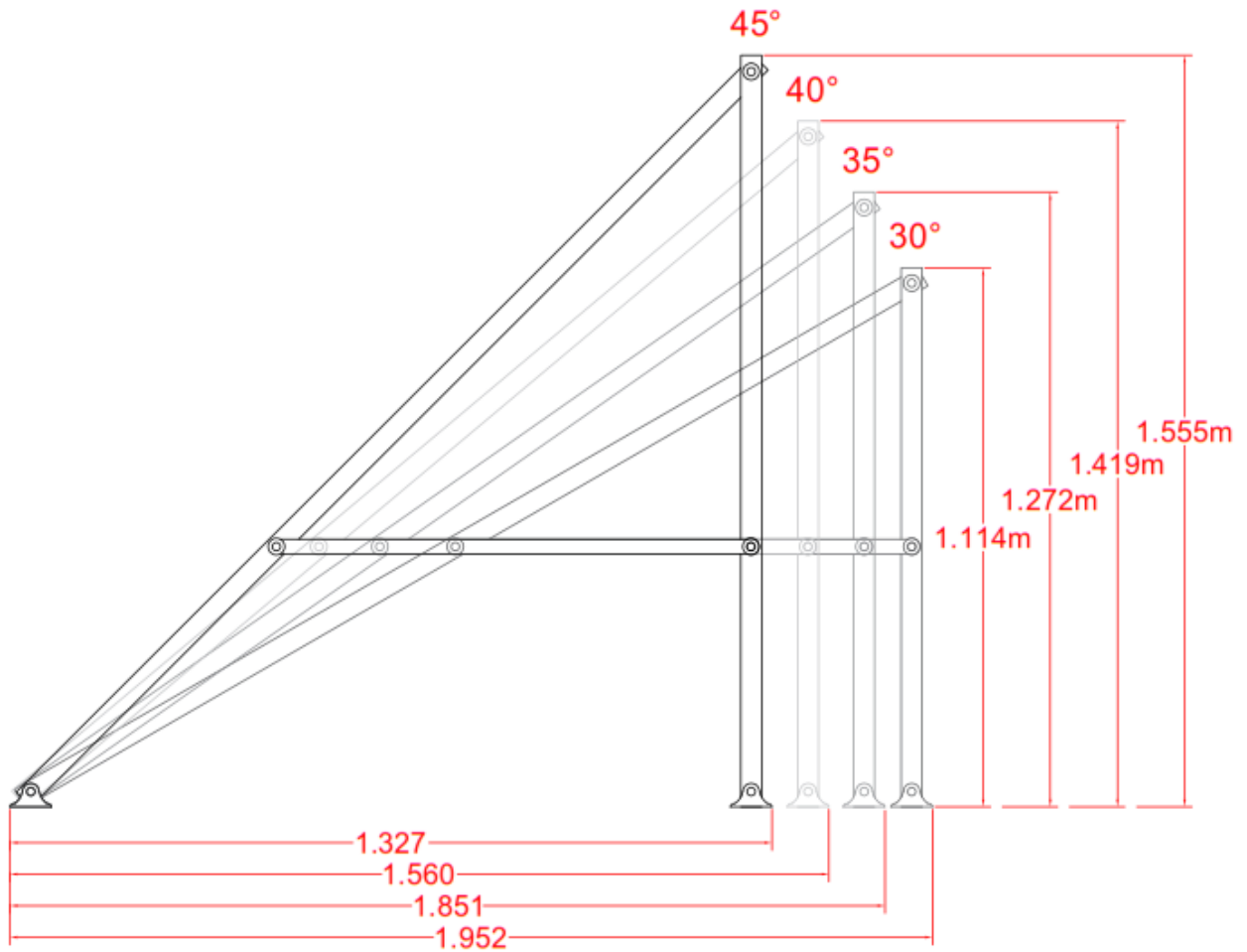

SOLAR PANEL INLET ASSEMBLY

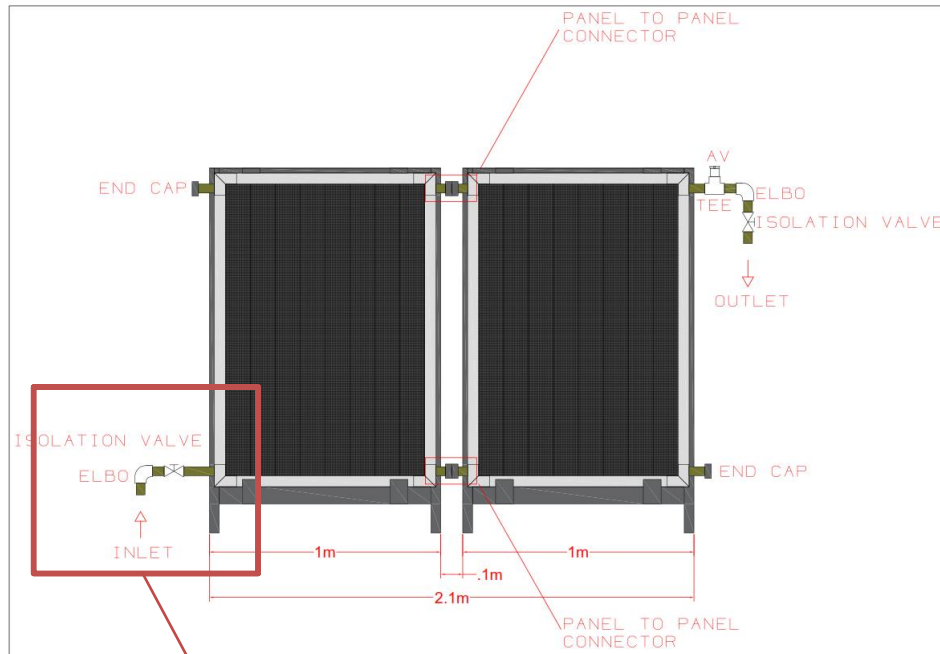

SOLAR PANEL TO PANEL ASSEMBLY KIT

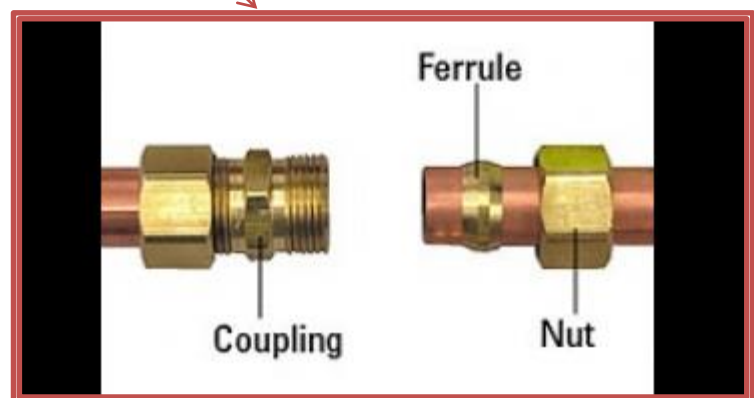
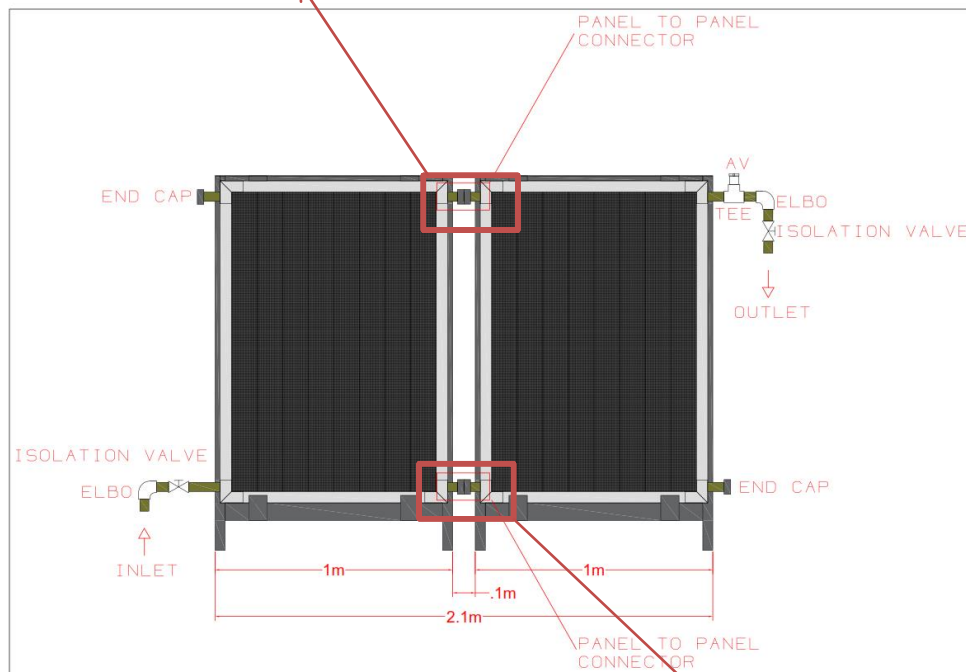
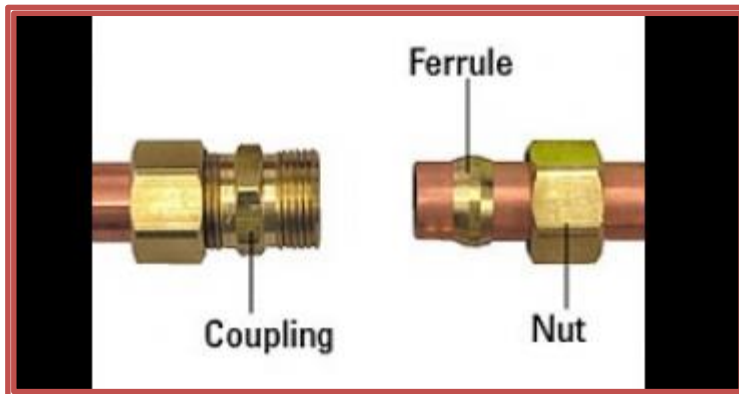

SOLAR PANEL OUTLET ASSEMBLY

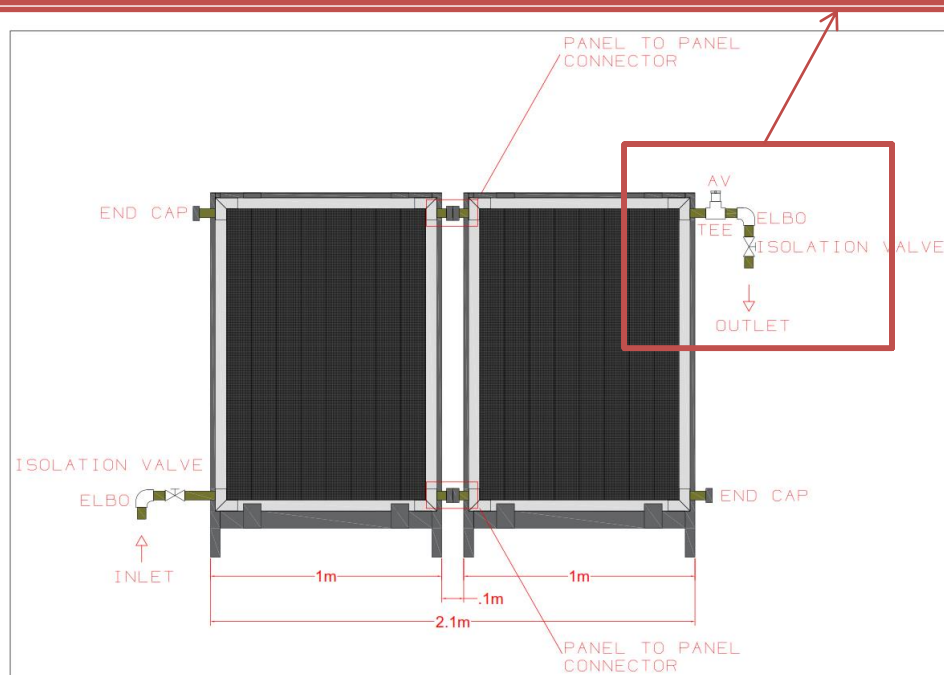

SOLAR PANEL SENSOR CONNECTION

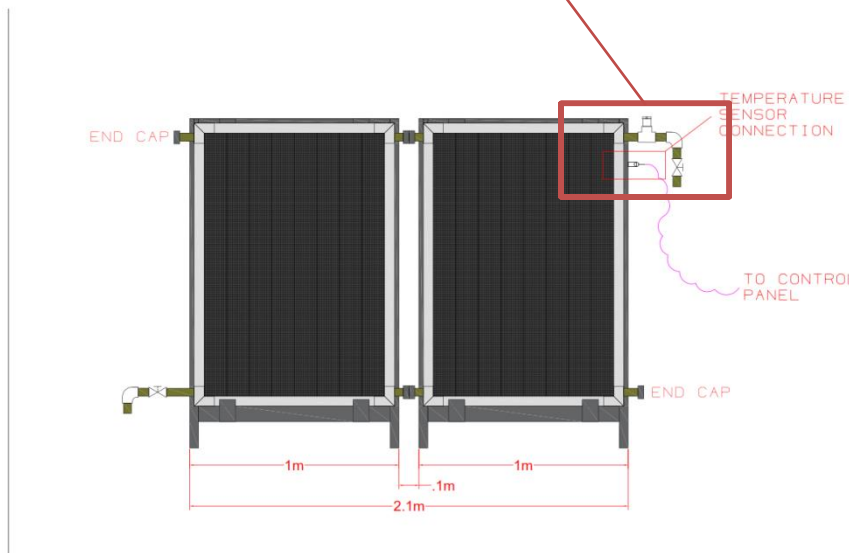

SOLAR CIRCULATION PUMP ASSEMBLY

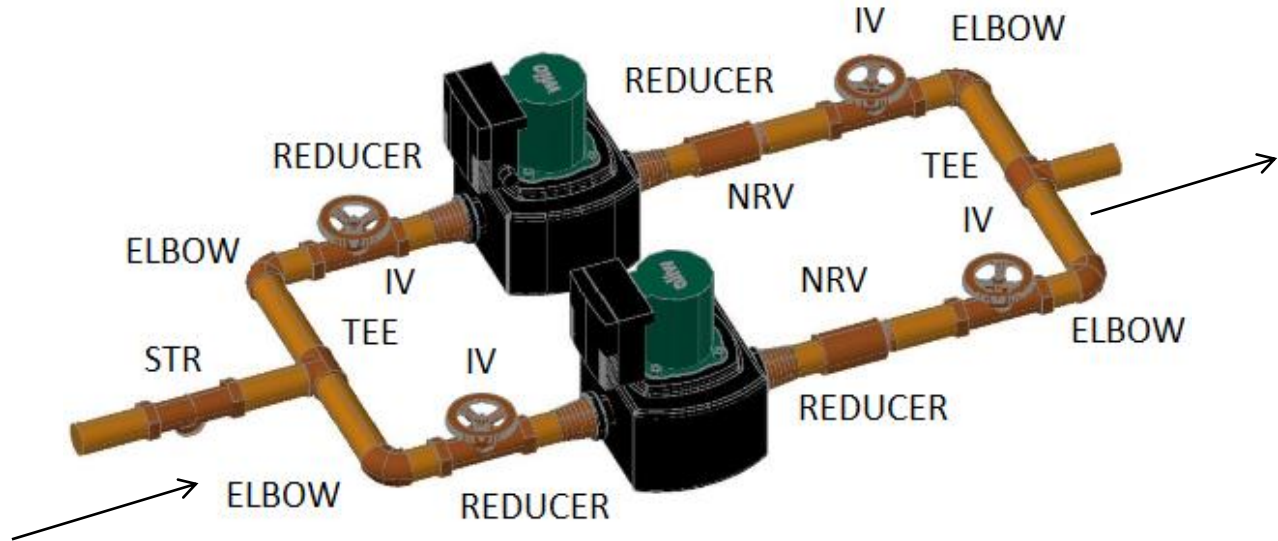

Number of Pumps		02 Nos	
Pipe Details		1" Pipe at 1 Length	
PUMP INLET (Common)			
SR. NO.	ITEM	SIZE	QTY
1	Strainer (STR)	1"	1
2	Socket	1"/28mm	1
3	Tee	28mm/28mm/1"	1
4	Elbow	1"	2
PUMP INLET			
1	Socket	1"	2
2	Isolation Valve (IV)	1"	2
3	Reducer	1-1/2"(F) / 1" (M)	2
PUMP OUTET			
1	Reducer	1-1/2"(F) / 1" (M)	2
2	Non Return Valve (NRV)	1"	2
3	Socket	1"/28mm	2
4	Isolation Valve (IV)	1"	2
5	Elbow	1"/28mm	2
6	Tee	28mm/28mm/1"	1

EXPANSION VESSEL ASSEMBLY

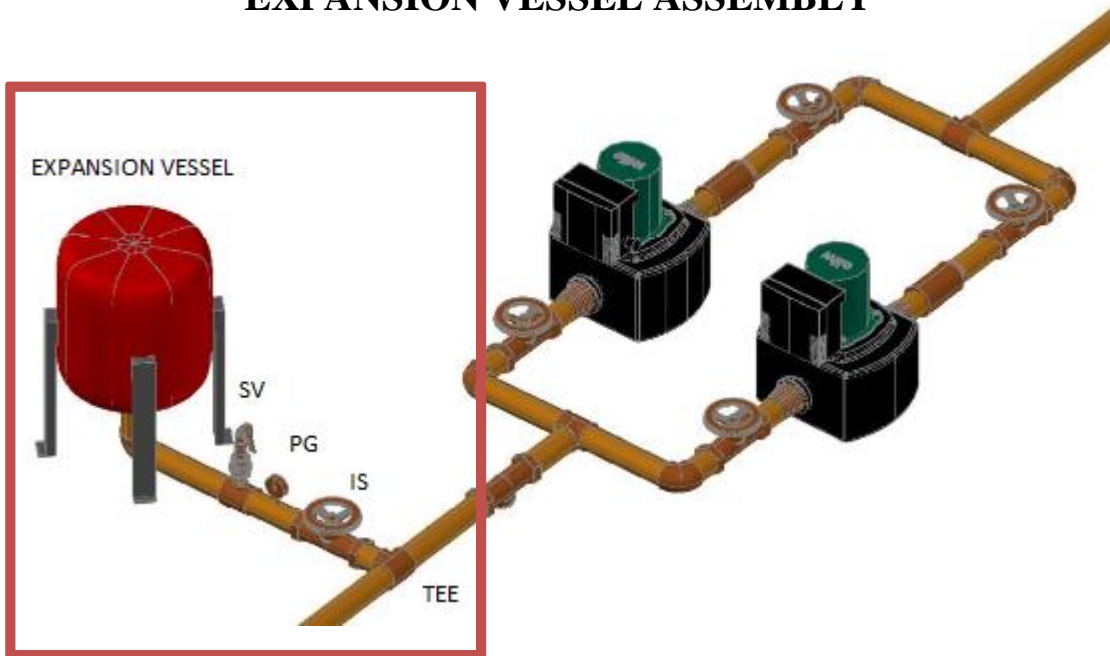

Number of Expansion Vessel		01 No.	
INLET			
SR. NO.	ITEM	SIZE	QTY
1	Isolation Valve (IS)	1"	1
2	Pressure Gauge (PG)	1"	1
3	Safety Valve (SV)	1"	1
Note:			
-Expansion Vessel to be Installed in the suction side of solar circulation pump			

EXPANSION VESSEL WITH PRE-COOL TANK ASSEMBLY

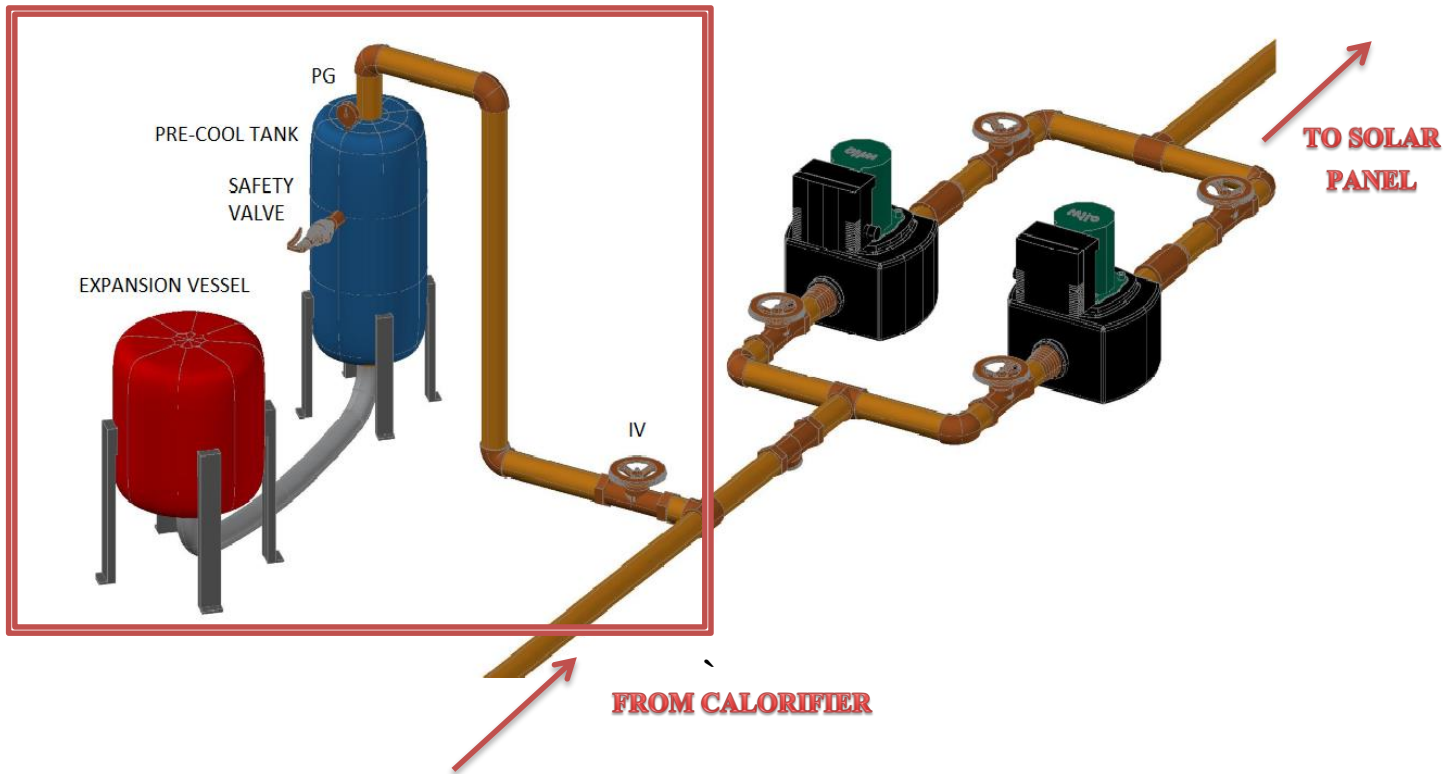

Number of Precool Tank		01 No.	
Number of Expansion Vessel		01 No.	
INLET			
SR. NO.	ITEM	SIZE	QTY
1	Isolation Valve (IS)	1"	1
2	Pressure Gauge (PG)	1"	1
3	Safety Valve (SV)	1"	1
Note:			
-Expansion Vessel to be Installed in the suction side of solar circulation pump			

EMERGENCY COOLER TANK ASSEMBLY

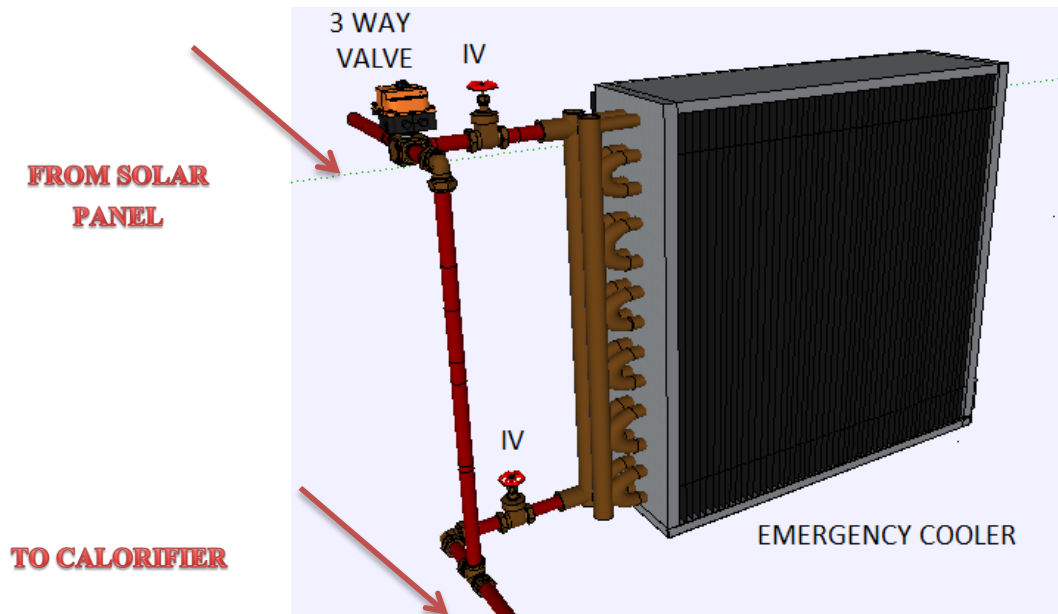

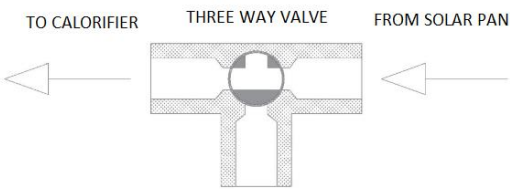
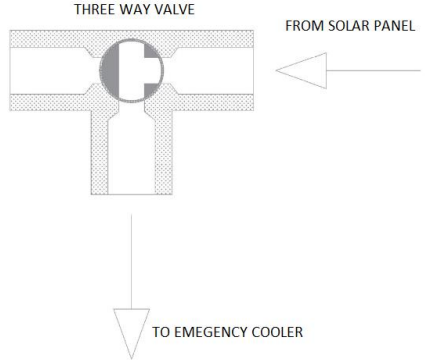
Number of Cooler		01 No.	
COOLER INLET			
SR. NO.	ITEM	SIZE	QTY
1	Three Way Valve		1
2	Isolation Valve		1
COOLER OUTLET			
1	Isolation Valve		1
Note: Three Way Valve Normal Operation		Note: Three Way Valve Cooling Operation	
			

FEEDER LINE ASSEMBLY

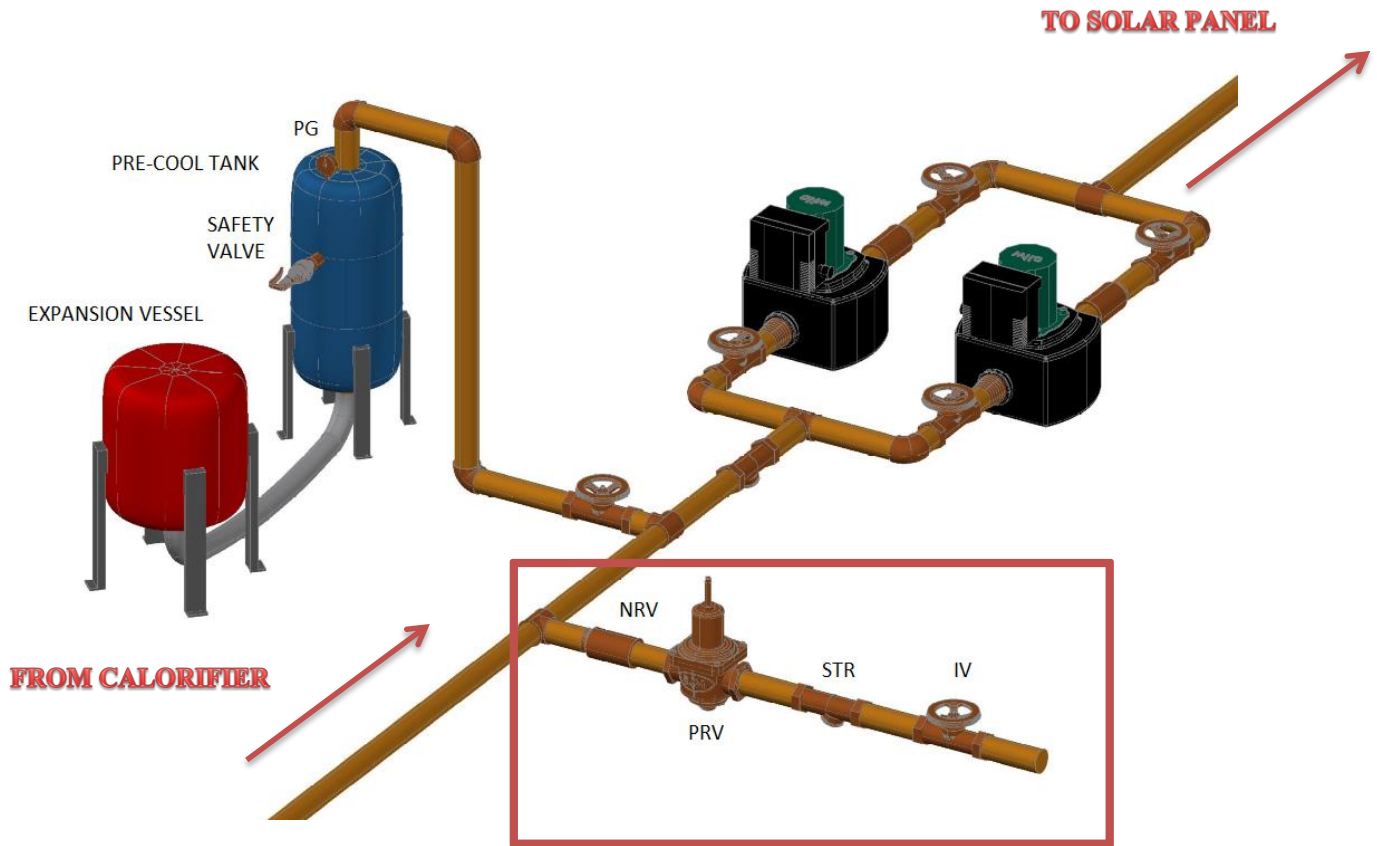

FEEDER LINE VALVES AND FITTINGS BOQ			
SR. NO.	ITEM	SIZE	QTY
1	Socket	1" / 28mm	1
2	Non Return Valve (NRV)	1"	1
3	Nipple	1"	1
4	Pressure Reducing Station (PRV)	1"	1
5	Nipple	1"	1
6	Strainer (STR)	1"	1
7	Nipple	1"	1
8	Isolation Valve (IS)	1"	1

NOTE:

-Primary/Solar Line Feeder Line should be installed at the suction side of the pump

CALORIFIER CONNECTION

MAGNESIUM ANODE



ANTI VACUUM VALVE



PRESSURE GAUGE



SENSOR

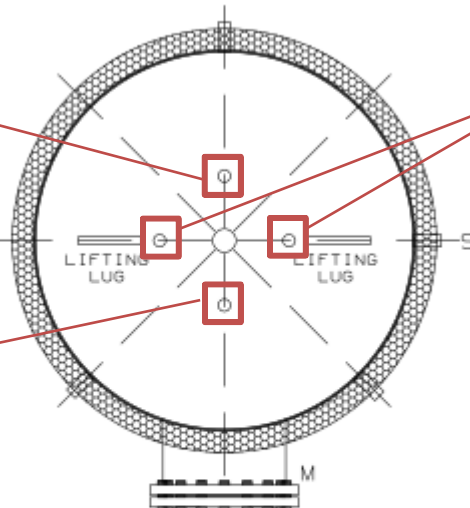

TOP CONNECTION

HOT WATER SUPPLY

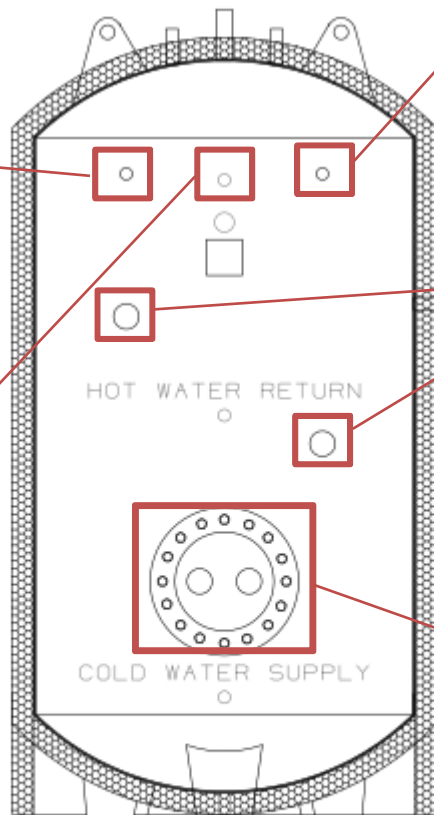

CONNECTION



SAFETY VALVE



TEMPERATURE GAUGE

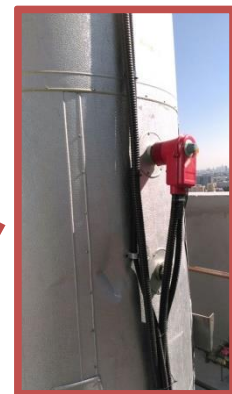

ELECTRIC HEATER

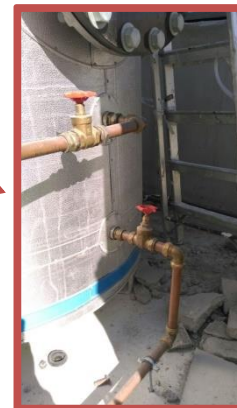

PRIMARY TOP INLET & BOTTOM OUTLET



Versol Poland | Versol Italy | Versol UK | Versol USA | Versol Middle East | Versol india

